

Zubehör Accessories

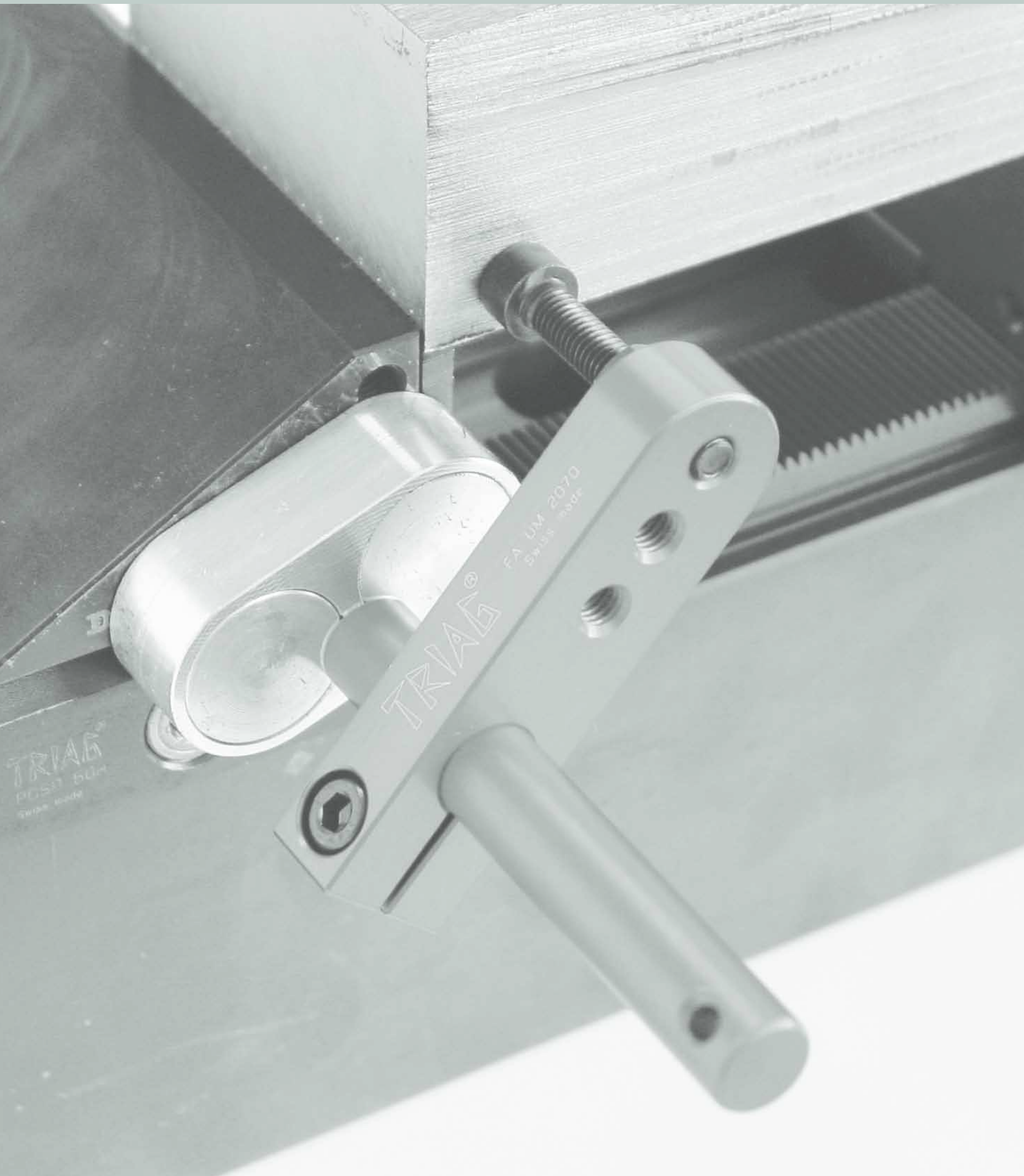



Einstellmassstab | *Measuring device* 335



Magnetanschlag | *Magnetic milling buffer* 336

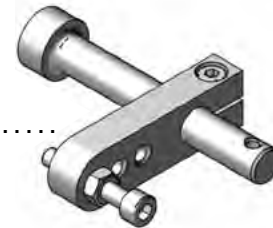

Zubehör | *Accessories* 337 - 340

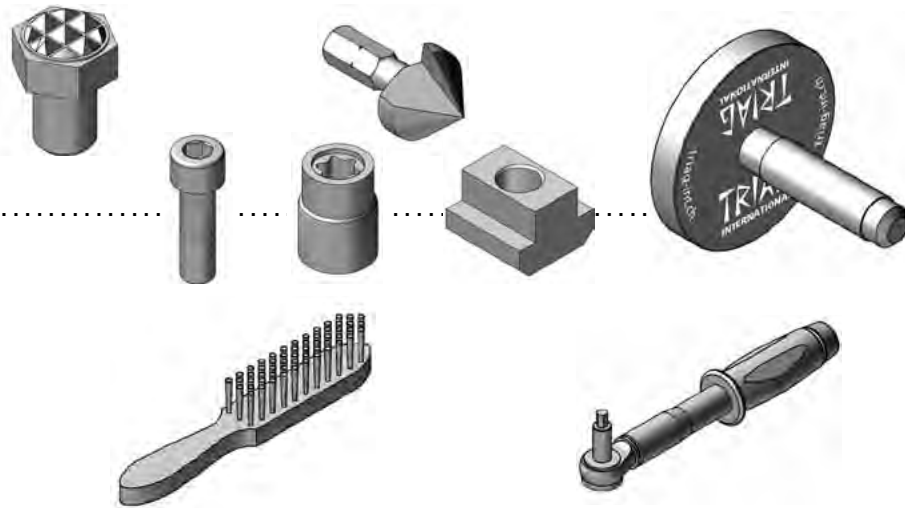



Masstab mit Magnetleiste
Scale with magnet profile

PCMAS800ML

- ① 1x PCMAS800ML
 - ② 2x MG1645 - M742C
 - ③ 2x M3x10 ISO 10642
 - ④ 1x M6x12 BN 5128
- kg ~1,0

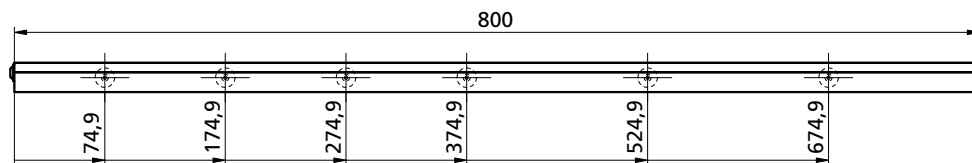

PCMAS700ML

- ① 1x PCMAS800ML
 - ② 2x MG1645 - M742C
 - ③ 2x M3x10 ISO 10642
 - ④ 1x M6x12 BN 5128
- kg ~0,88

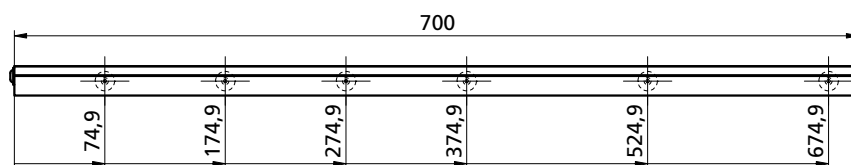

PCMAS600ML

- ① 1x PCMAS800ML
 - ② 2x MG1645 - M742C
 - ③ 2x M3x10 ISO 10642
 - ④ 1x M6x12 BN 5128
- kg ~0,75

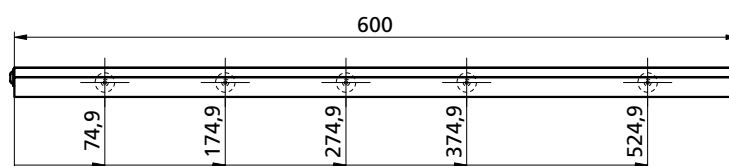

PCMAS500ML

- ① 1x PCMAS800ML
 - ② 2x MG1645 - M742C
 - ③ 2x M3x10 ISO 10642
 - ④ 1x M6x12 BN 5128
- kg ~0,63

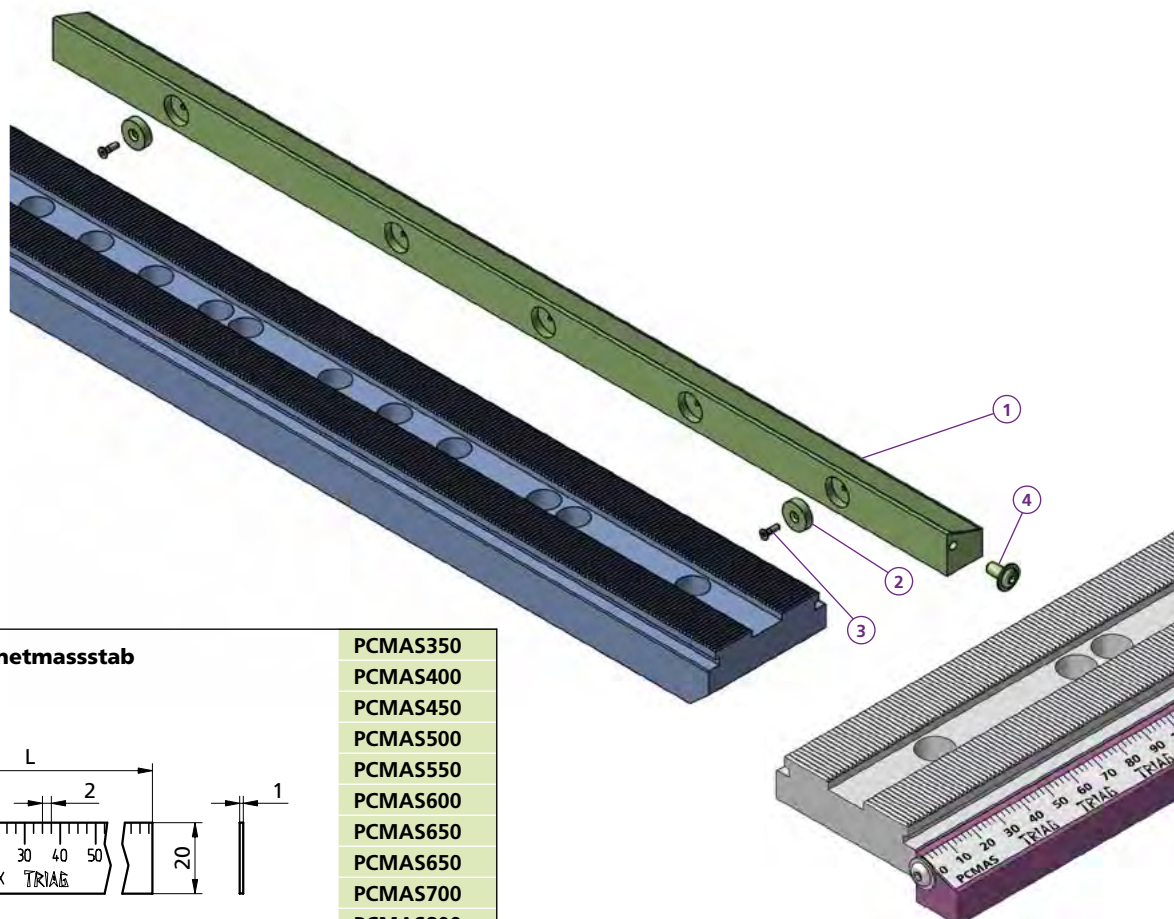
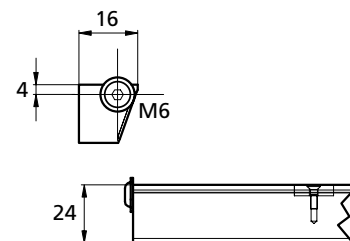
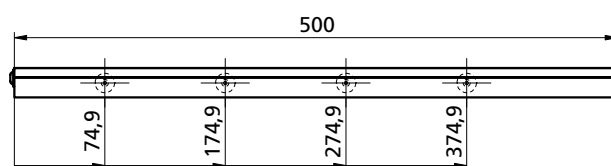

Alu - Magnetmasstab
Alu scale

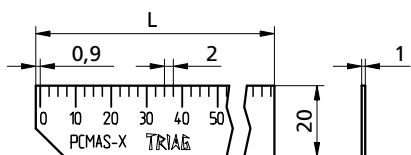

- PCMAS350
- PCMAS400
- PCMAS450
- PCMAS500
- PCMAS550
- PCMAS600
- PCMAS650
- PCMAS650
- PCMAS700
- PCMAS800

Bestellbeispiel / Ordering example : PCMAS800ML

Separat bestellen / Separate order



Die einfache Platzierung ermöglicht schnelles Montieren und wieder Entfernen auch auf der 5-Achsen-Maschine!

Easy positioning makes quick mounting and lifting possible also on five axes machines!

Die 3 Sicherheitsstufen:

Durch seine **rote Farbe** ist der Anschlag besser sichtbar, was das Risiko vermindert, dass er in der Maschine vergessen wird.

Die **Bohrung** dient zum Befestigen einer Schnur am Handgelenk oder ausserhalb der Maschine.

Dank dem **Magnet** ist der Anschlag auf allen magnetischen Materialien auf minimalem Platz einsetzbar, bei Kollision wird er weggedrückt. Es entstehen so keine teuren Werkzeugbrüche oder Maschinendefekte.

The 3 safety levels:

Because of its **red color**, the buffer is better visible. So the risk of forgetting the device in the machine is diminished.

The **drilling** serves to fasten a cord around the wrist or outside the machine.

Its **magnet** makes the buffer applicable on all magnetic materials on minimum space, in case of collision it gets pressed away, so there won't be any expensive breaking of tools or machines.

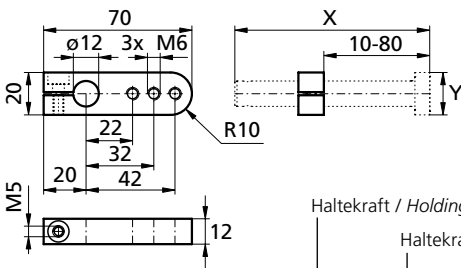

Haltekraft / Holding force: 45N = 4,5daN (~4,5 kg)

Haltekraft / Holding force: 80N = 8daN (~8 kg)

FAUM2070	FAUM2070S
1x FA2070	1x FA2070
1x FAD2092	1x FAD2092S
2x MG1645	1x MG2570
2x M6 ISO 4032	1x M6 ISO 4032
1x M6x35 ISO 4762	1x M6x35 ISO 4762
1x M5x14 ISO 4762	1x M5x14 ISO 4762
1x M3x8 ISO 10642	1x M5x16 ISO 10642
X = 92	X = 95
Y = ø 20	Y = ø 25
kg ~0,084	kg ~0,1

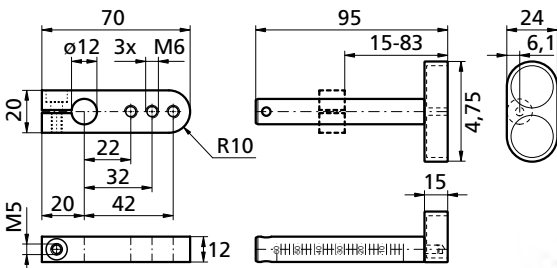
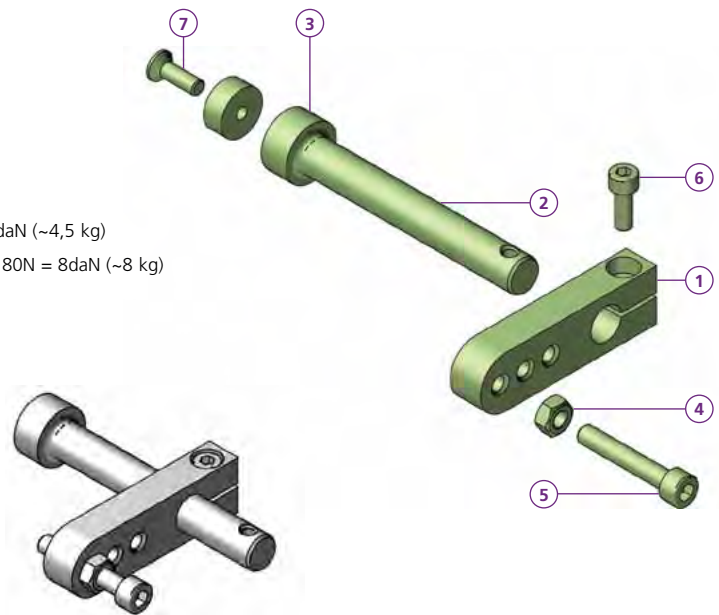

Haltekraft / Holding force: 120N = 12daN (~12 kg)

FAUM2070US
1x FA2070
1x FAD1280
1x FUSSUS
1x M6 ISO 4032
1x M6x35 ISO 4762
1x M5x14 ISO 4762
kg ~0,146

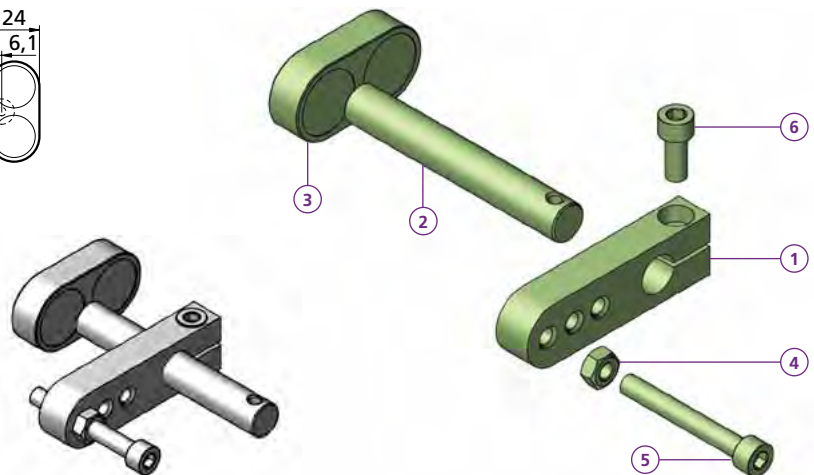

Bestellbeispiel Ordering example : **FAUM2070US**



Fräsanschlag / Milling buffer

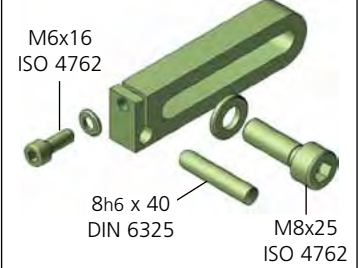
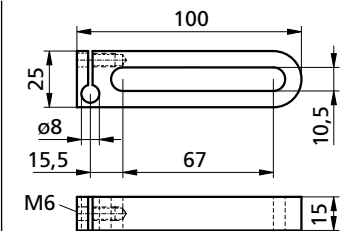
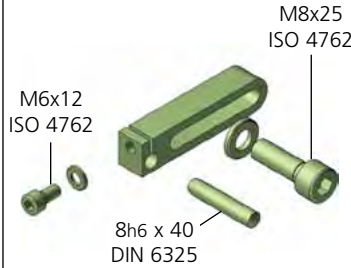
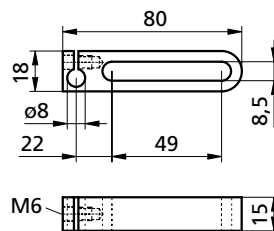
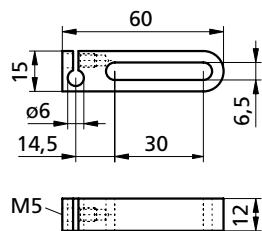
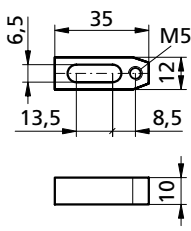

FA1240	kg	~0,024	FA1260	kg	~0,07	FA1280	kg	~0,014	FA12100	kg	~0,022
---------------	----	--------	---------------	----	-------	---------------	----	--------	----------------	----	--------

**Distanzbüchse zu Fräsanschlag
Spacers for workpiece stop**

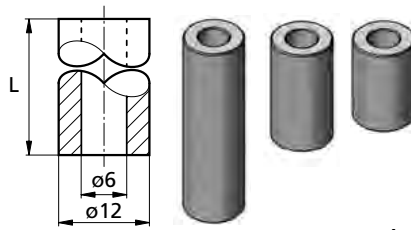
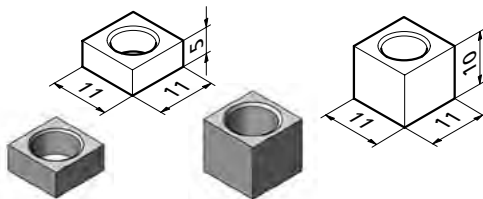

	L	kg
FAD12018	18	~0,012
FAD12023	23	~0,016
FAD12040	40	~0,026

CCD005	CCD010	FAD12040	CCBX0802
---------------	---------------	-----------------	-----------------

**Positionierstift (spreizbar)
Locating pin (expandable)**

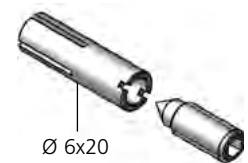

Druckstift / Gripping pins

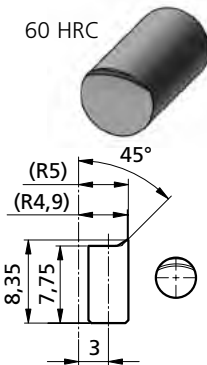
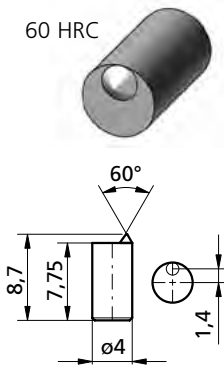
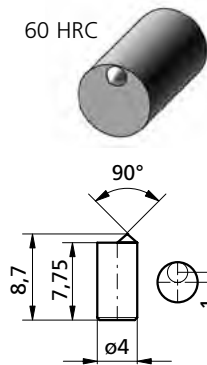
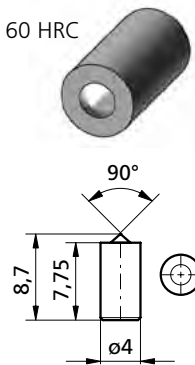

**Einbauanleitung
Installation guide**
Bohrung vorbereiten
Preparation of drill-hole
Einkleben mit / Glue with
Loctite 641

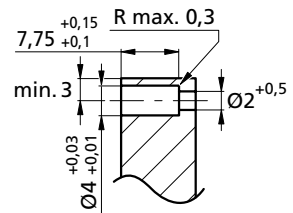

DS0402-90°	DSE0402-60°	DSE0402-90°	DSE0402-BS
-------------------	--------------------	--------------------	-------------------

**Hartmetalldruckstück
Carbide gripper**

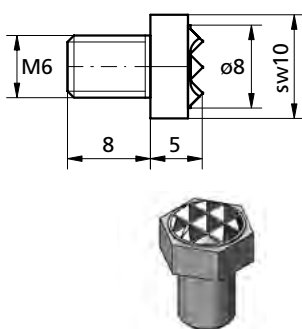

CCHMR

**Prägespannschraube
Stamping roll screw**

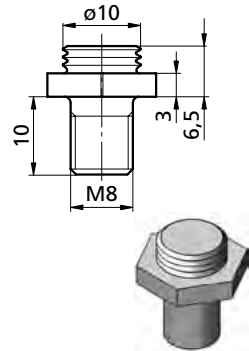

PRG1003M8

**Kugeldruckstück
Gripper**

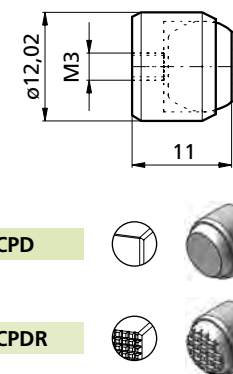

CCPD
CCPDR

**Ausrichtzapfen für T-Nuten
Alignment-pins for t-slots**

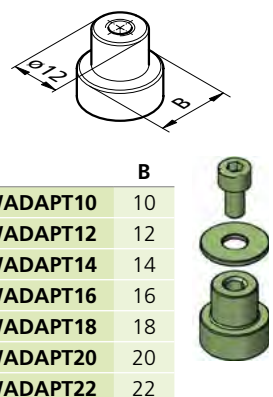

	B
TWADAPT10	10
TWADAPT12	12
TWADAPT14	14
TWADAPT16	16
TWADAPT18	18
TWADAPT20	20
TWADAPT22	22

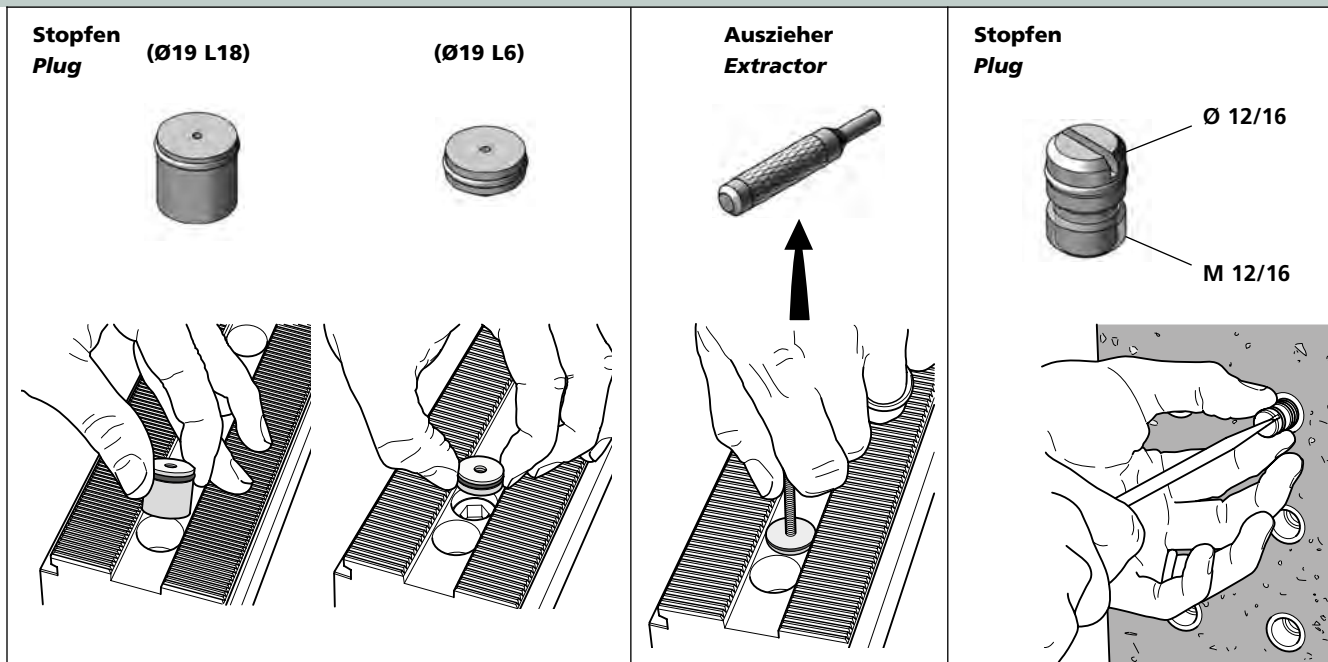

PCPF16L18 PCPF16L6 PCAZM3 CCPF12ALU / CCPF16ALU

Spannschrauben (Nitriert) Clamping screw (Nitrided)		Passschrauben Fitting screw		M5 / M6 / M12 / M16	
				D	G
				L	B
				K	sw
				Nm	kg
M8x20ISO4762NQ	B60	~0,012			
M10x25ISO4762NQ	B80	~0,024			
				MS50	5 f7
				MS60	6 f7
				TWPAS1250	12 g7
				TWPAS1240	12 g7
				TWPAS1232	12 g7
				TWPAS1227	12 g7
				TWPAS16055	16 f7

Reduktionshülsen für Rasterplatte Reduction sleeve for grid plate		Bohrbüchsen Position case	
		L	D
		d	
RD16M1612M12	RD18M1612M12	CCBUE121812	12 18,0 12,0
		CCBUE1218512	12 18,5 12,0
		CCBUE121912	12 19,0 12,0
		CCBUE162616	16 26,0 16,0

T-Nuten Steine / T-nuts			Nutensteine, flach Fixed slot tenons			Nutensteine, fest Fixed slot tenons		
d	α	kg	L	d		H	L	b
								slot size
SM1135M06X08	~0,012		SM1135M12X22	~0,188		NT2012	22	12 20 M6x10
SM1135M06X10	~0,012		SM1135M14X16	~0,188		NT2014	10	14 20 M6x10
SM1135M08X10	~0,012		SM1135M14X18	~0,188		NT2016	25	16 20 M6x10
SM1135M08X12	~0,022		SM1135M16X18	~0,068		NT2018		18 20 M6x10
SM1135M08X14	~0,04		SM1135M16X20	~0,11		NT2022	12	22 20 M6x12
SM1135M10X12	~0,02		SM1135M18X20	~0,11		NT2024	32	24 20 M6x12
SM1135M10X14	~0,038		SM1135M18X22	~0,15				
SM1135M12X14	~0,045		SM1135M20X22	~0,15				
SM1135M12X16	~0,045		SM1135M20X24	~0,23				
SM1135M12X18	~0,078		SM1135M24X28	~0,31				
SM1135M12X20	~0,13		SM1136-20					

Pneumatikschrauber Set

Pneumatic screwdrivers set

Triag Bitburr / Triag Bit



Zubehör / Accessories

Pneumatikschrauber Set

Pneumatic screwdrivers set

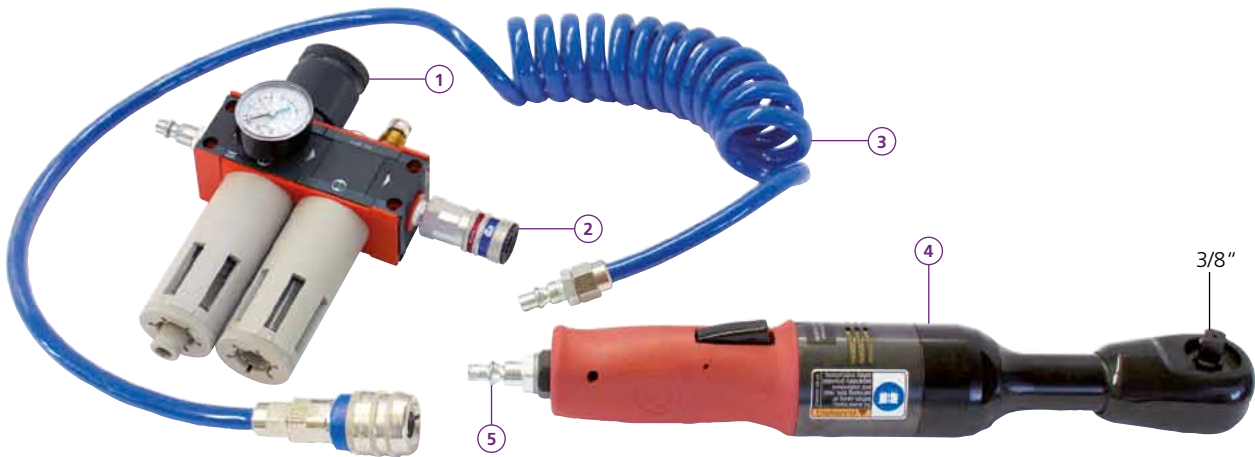

RP9431SET

- ① 1x P1H-200-M3QG
 - ② 1x 103002152 (SERIE 300) 1/4"
 - ③ 1x 19 958 9977 (5 x 8 mm, 300, 2 m)
 - ④ 1x RP9431
 - ⑤ 1x 103105152 1/4"
- kg ~1,5

Drehmomenttabelle Torque table	Druck (bar) Compression	Nm
	6	50
Schlauchdurchmesser 8 mm	5,5	45
Luftverbrauch 2,5 L Sek	5	40
	4,5	35
Hose diameters 8 mm	4	30
Air consumption 2,5 L sec	3,5	25
	3	20

mit Feder gehalten, nicht magnetisch
spring locked, not magnetic



Triag Bit

mit Feder gehalten, nicht magnetisch
spring locked, not magnetic



siehe Video
see video

Triag Bitburr

Luftpistolen Gummiadapter

Air gun rubber adapter

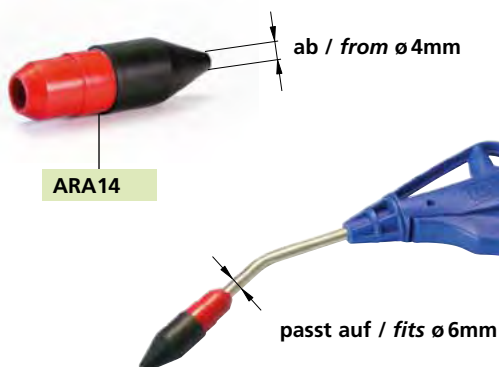

ARA14

Einsätze zu Bitburr

Inserts for Bitburr



TC10



BitF63 Ø 6,3-90°



BIT-KH



BitF104 Ø 10,4-90°

Magnethalter

Magnetic holder



Smiley



BIT-BF



BitF165 Ø 16,5-90°

Bestellbeispiel / Ordering example: RP9431SET



Drehmomentschlüssel
Torque wrench

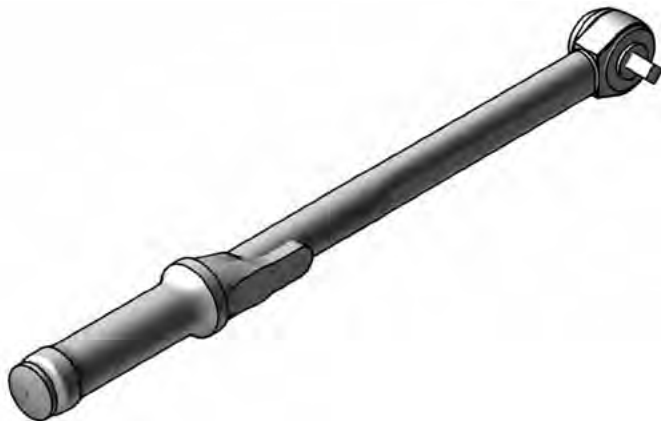

(L) lang
(L) long



(LK) lang mit Kugelkopf
(LK) long with ball head

(LK)

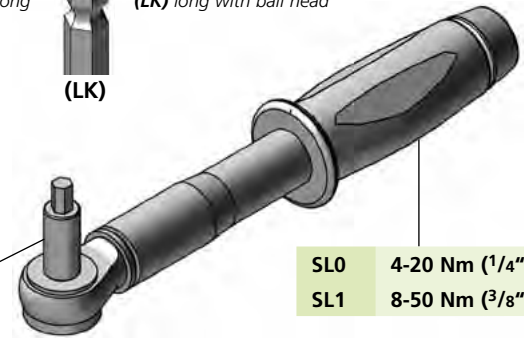

SL0 4-20 Nm (1/4")
SL1 8-50 Nm (3/8")

Sechskantstifteinsatz / Hexagonal socket wrench

Nuss 1/4"	4 mm	Nuss 3/8"	5 mm	L / LK
	5 mm		6 mm	L / LK
	6 mm		8 mm	L / LK
	8 mm		10 mm	L / LK

SL3 20-200 Nm (1/2")

Steckschlüsseleinsatz
Socket wrench insert



Torx

Sechskanteinsatz
Hexagon insert

Sechskantstifteinsatz
Hexagonal socket wrench

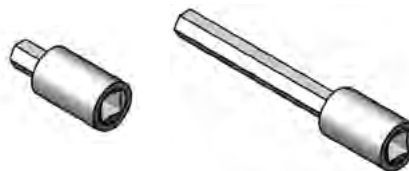

AD-BIT-1/4-1/4



AD-BIT-1/4-3/8



NUSS 3/8" TX30E14 für / for MCZ..., ZSX..., ZSM..., ZSB..., PCZ...

Nuss 1/4" 4,5 mm für / for MCZ40L30,
Nuss 1/4" 5,5 mm UB5AXSET3, PCZ80L40PRG62

Nuss 1/2" L 14 mm Nuss 1/2" 10 mm
14 mm

Spannschlüssel
Clamping wrench



02613160	4 mm
02613164	5 mm
02613168	6 mm
02613172	8 mm
02613176	10 mm

Langer Spannschlüssel
Long clamping wrench

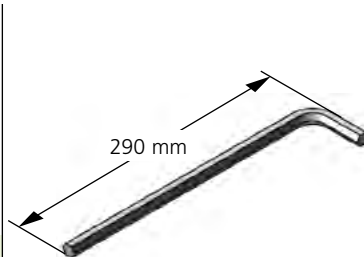

ISL10 sw = 10 mm
ISL14 sw = 14 mm

Messingdrahtbürste
Brass wire brush

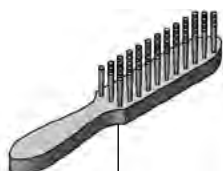

PCMB4



Triag Ei

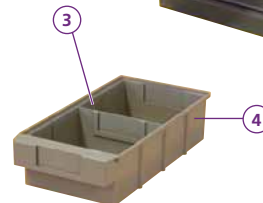

KALST powerCLAMP

- 1 7x
- 2 1x PCB...
- 3 16x
- 4 16x

KALST aptoCLAMP

- 1 7x
- 2 1x ACB...
- 3 16x
- 4 16x