



Unscrew the stop screw completely



Remove 4 setscrews



Pull out spindle with center bearing and carriage



Remove the carriage from spindle



Replace spindle and center bearing



Install spindle with center bearing

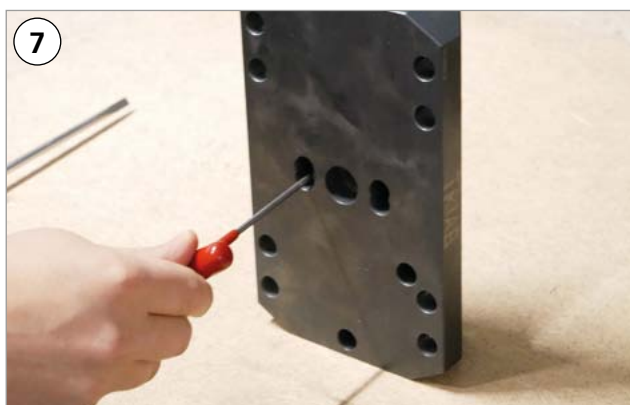

Pre-position middle bearing with 4 set screws in center (do not wear tight yet!)



Retract carriage (label outside)

Zero point adjustment



Carriage with recess, on the side of the stop screw



Squeeze carriage with screwdriver! Caution: The carriages must both reach into the spindle thread at the same time!



Check whether both carriages have the same distance to the housing. If this is not the case, the carriages must be retracted again!



Use gauge block and clamp slightly.

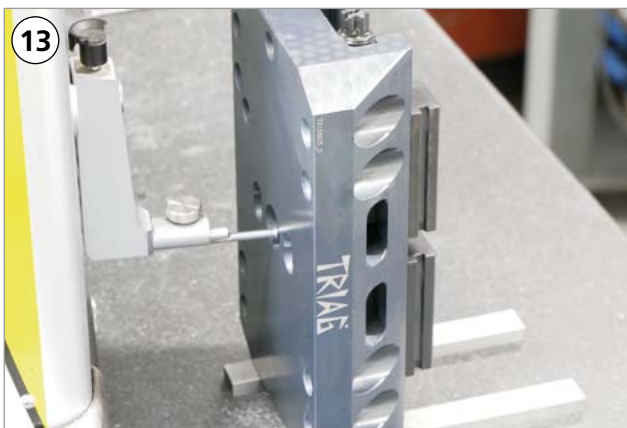

Place the vise upright on the underlays and center it on the button side of the vise and set the zero point.

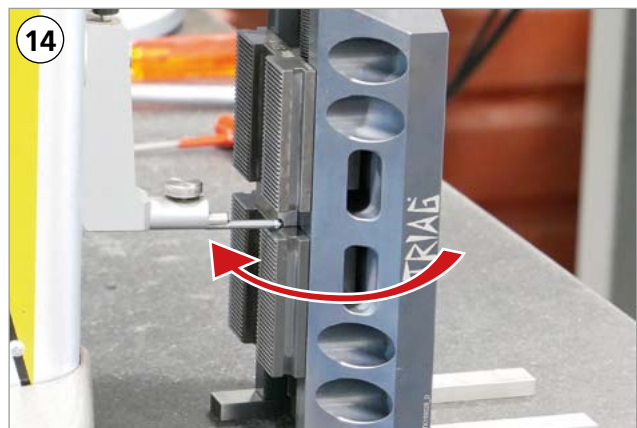

Turn the vise around and measure in between the carriages.



If + **Difference**: Tighten both lower set screws evenly



If - **Difference**: Tighten both upper set screws evenly



At the end, all 4 set screws must be tightened evenly.

