

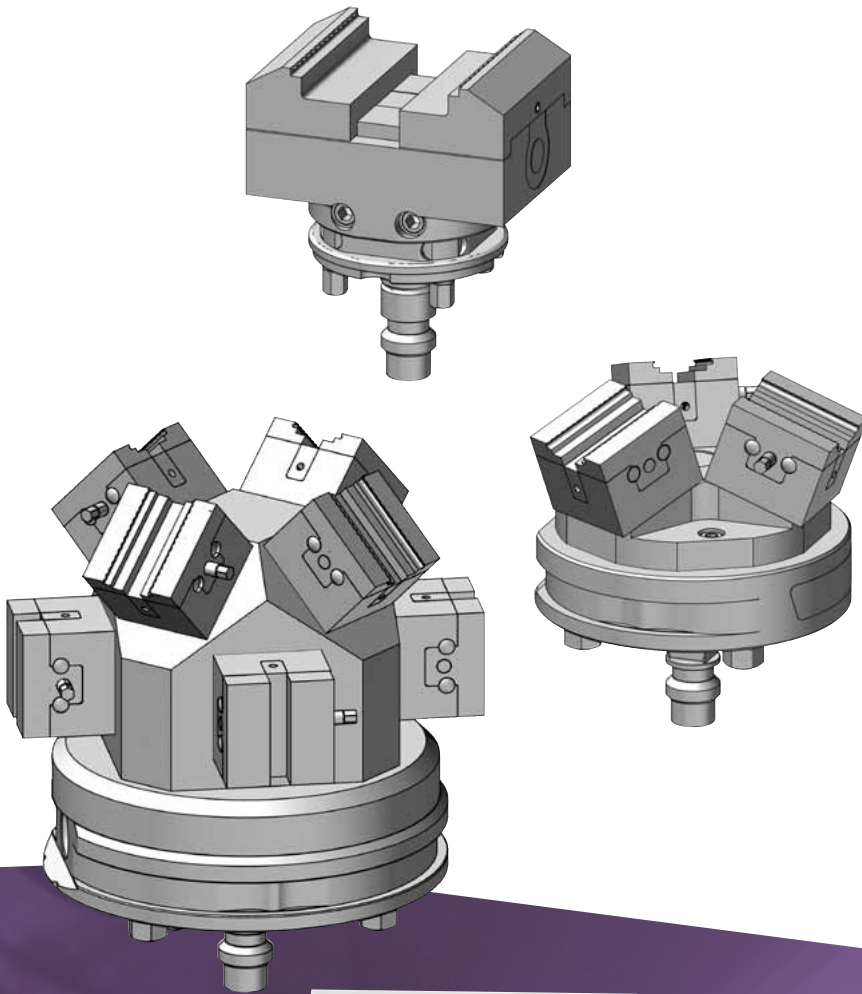

Maschinenspezifische Spannlösungen  
*Machine specific workholding solutions*



**TRIAG**  
**INTERNATIONAL**



RXP500DS  
RXP500DSC  
RXP501DS  
RXP501DSC





# triCENTRO

**5-Achs Mehrfachspannpyramide mit Erowa Schnittstelle**  
*5-axis multiple workholding pyramid with Erowa interface*

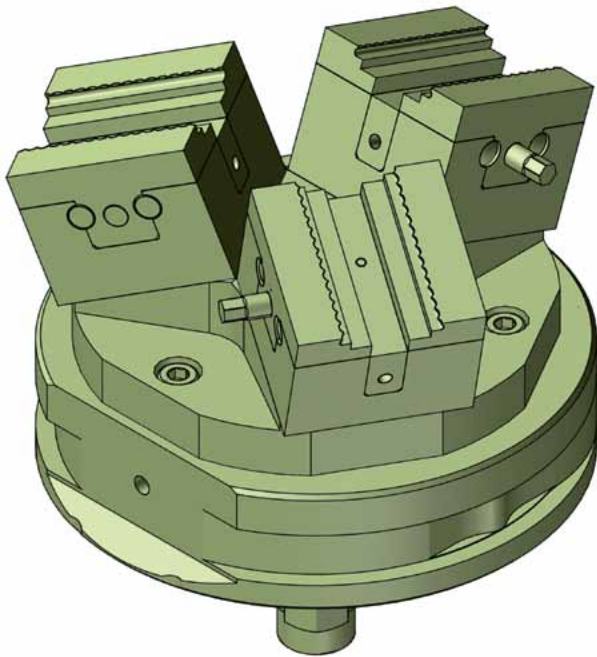

**7 Backenvarianten**  
*Jaw variants*

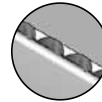

**2,2 mm Direkt-Prägebacken**  
*2,2 mm Direct stamping jaws*



**«Sputnik» 5-Achs Mehrfachspannpyramide**  
*«Sputnik» 5-axis multiple workholding pyramid*

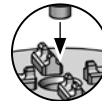

**EROWA Schnittstelle**  
*EROWA interface*



**Beste Zugänglichkeit**  
*Best accessibility*

Bestellschlüssel <i>Order code</i>	Bezeichnung <i>Description</i>	~ Kg	Spannstellen <i>Clamping areas</i>	Winkel <i>Angle</i>	Spannbereich <i>Clamping area</i>
<b>RD500-SET1</b>	Röders Set 1	3,65	3	20°	12 - 22

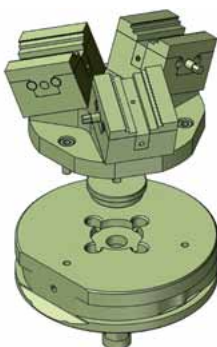

Drehmoment <i>Torque</i>		Spannkraft <i>Workholding force</i>		
Nm	(lb-ft)	~daN	~(lb)	~t
4	3	= 457	1'007	0,46
5	3,7	= 571	1'259	0,57
6	4,4	= 686	1'512	0,69
7	5,2	= 800	1'764	0,8

**Backen gemäss Zusammenstellzeichnung falls nicht anders vereinbart.**

*Jaws according to assembly drawing if not agreed otherwise.*

**röders**  
**TEC**



RXP 500 DS / DSC



RXP 501 DS / DSC

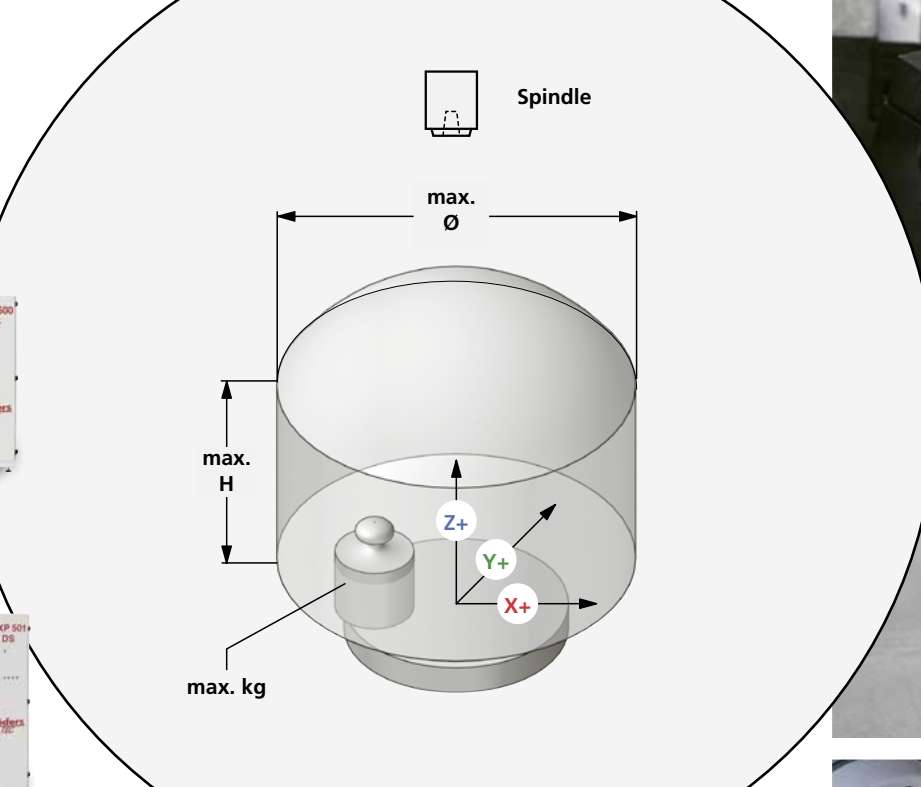

	X	Y	Z	max.		
				Ø	H	kg
RXP500DS	450 (X-316 X+134)	658 (Y-204 Y+454)	240	250	220	60
RXP500DSC	450 (X-316 X+134)	658 (Y-204 Y+454)	240	220	200	30
RXP501DS	500 (X-366 X+134)	700 (Y-230 Y+470)	300	250	200	60
RXP501DSC	500 (X-366 X+134)	700 (Y-230 Y+470)	300	220	200	30

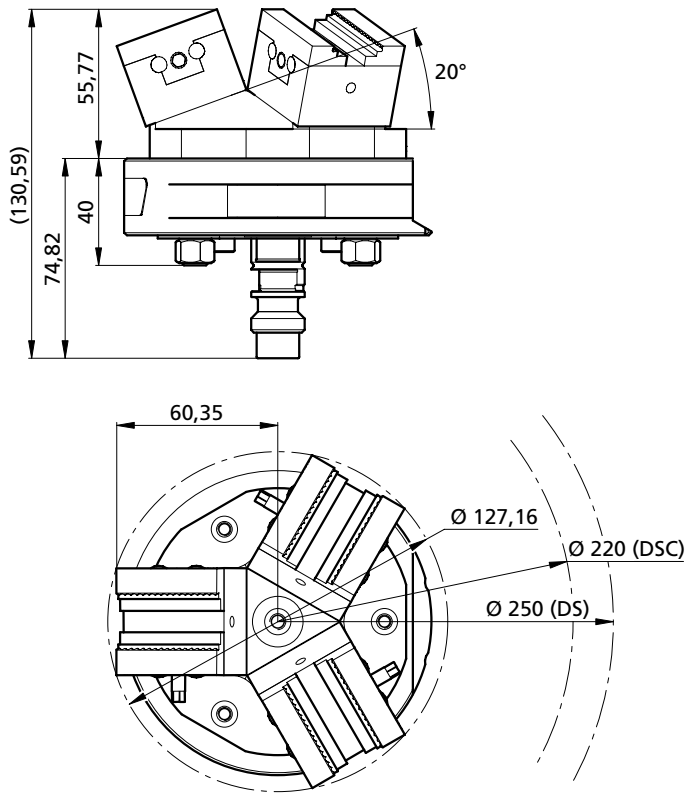

**MICRO**

**Backenvarianten**  
*Jaw variants*

**Mehr auf Seite 11**  
*More on page 11*

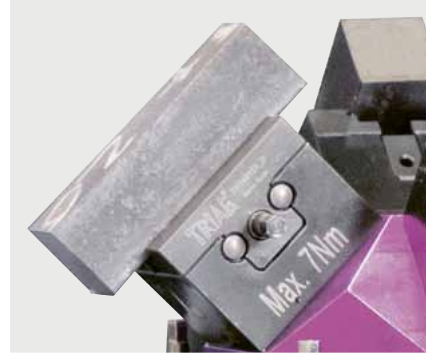



# triCENTRO

5-Achs Mehrfachspannpyramide mit Erowa Schnittstelle  
 5-axis multiple workholding pyramid with Erowa interface

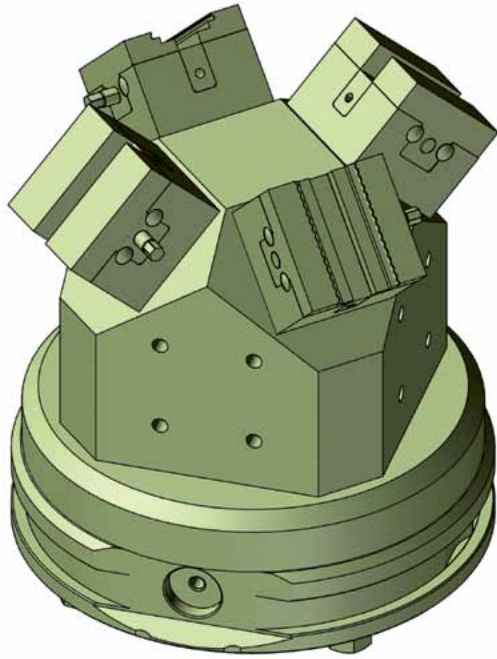

**7** Backenvarianten  
 Jaw variants

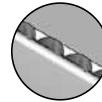

**2,2 mm Direkt-Prägebacken**  
 2,2 mm Direct stamping jaws



**«Sputnik» 5-Achs Mehrfachspannpyramide**  
 «Sputnik» 5-axis multiple workholding pyramid

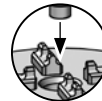

**EROWA Schnittstelle**  
 EROWA interface



**Beste Zugänglichkeit**  
 Best accessibility

Bestellschlüssel Order code	Bezeichnung Description	~ Kg	Spannstellen Clamping areas	Winkel Angle	Spannbereich Clamping area
<b>RD500-SET2</b>	Röders Set 2	4,13	4	45°	12 - 22

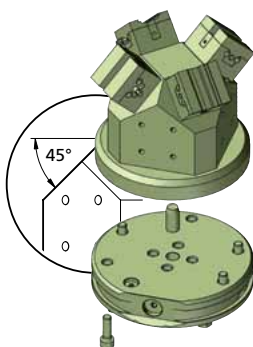

Drehmoment Torque		Spannkraft Workholding force		
Nm	(lb-ft)	~daN	~(lb)	~t
4	3	= 457	1'007	0,46
5	3,7	= 571	1'259	0,57
6	4,4	= 686	1'512	0,69
7	5,2	= 800	1'764	0,8

**Backen gemäss Zusammenstellzeichnung falls nicht anders vereinbart.**

*Jaws according to assembly drawing if not agreed otherwise.*

**röders**  
**TEC**



RXP 500 DS / DSC



RXP 501 DS / DSC

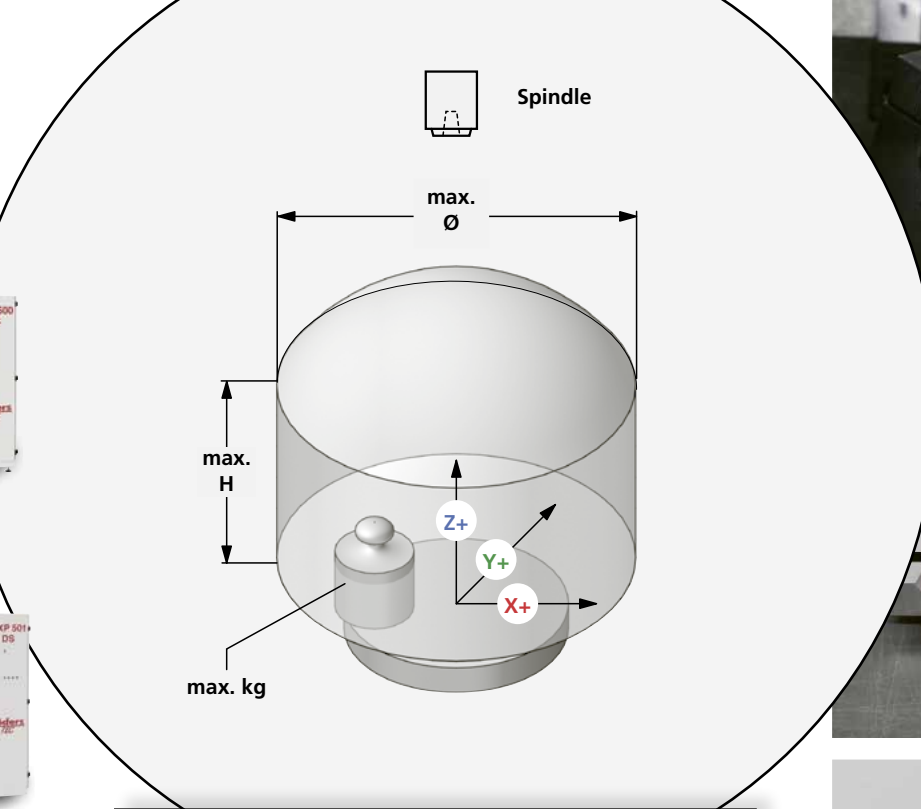

	X	Y	Z	max.		
				Ø	H	kg
RXP500DS	450 (X-316 X+134)	658 (Y-204 Y+454)	240	250	220	60
RXP500DSC	450 (X-316 X+134)	658 (Y-204 Y+454)	240	220	200	30
RXP501DS	500 (X-366 X+134)	700 (Y-230 Y+470)	300	250	200	60
RXP501DSC	500 (X-366 X+134)	700 (Y-230 Y+470)	300	220	200	30

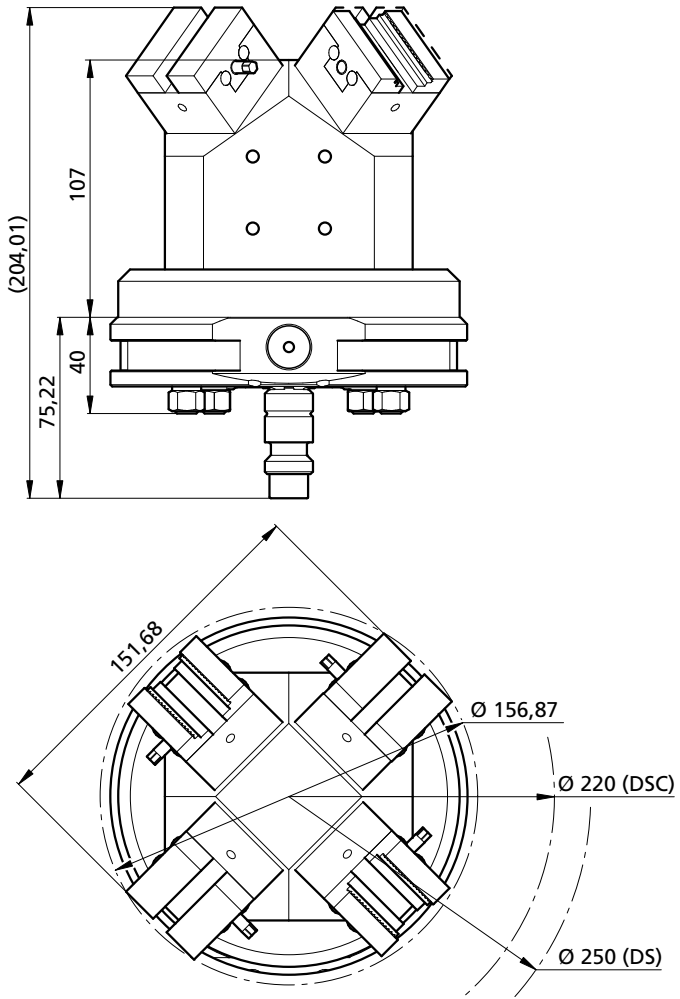

**MICRO**

Backenvarianten  
Jaw variants

Mehr auf Seite 11  
More on page 11

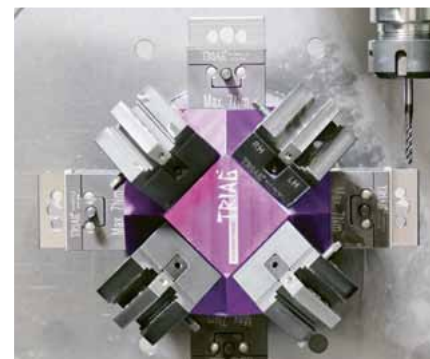



## triCENTRO

5-Achs Mehrfachspannpyramide mit Erowa Schnittstelle  
5-axis multiple workholding pyramid with Erowa interface

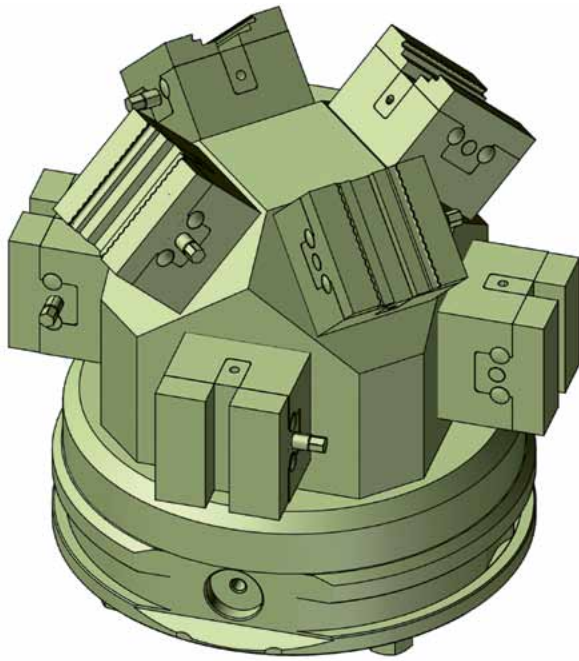

**7** Backenvarianten  
Jaw variants

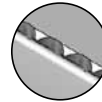

**2,2 mm Direkt-Prägebacken**  
2,2 mm Direct stamping jaws



**«Sputnik» 5-Achs Mehrfachspannpyramide**  
«Sputnik» 5-axis multiple workholding pyramid

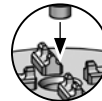

**EROWA Schnittstelle**  
EROWA interface



**Beste Zugänglichkeit**  
Best accessibility

Bestellschlüssel Order code	Bezeichnung Description	~ Kg	Spannstellen Clamping areas	Winkel Angle	Spannbereich Clamping area
<b>RD500-SET3</b>	Röders Set 3	<b>8,7</b>	<b>8</b>	<b>45°</b>	<b>12 - 22</b>

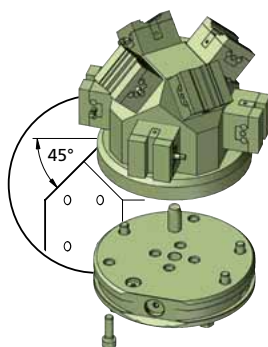

Drehmoment Torque		Spannkraft Workholding force		
Nm	(lb-ft)	~daN	~(lb)	~t
<b>4</b>	3	= 457	1'007	0,46
<b>5</b>	3,7	= 571	1'259	0,57
<b>6</b>	4,4	= 686	1'512	0,69
<b>7</b>	5,2	= 800	1'764	0,8

**Backen gemäss Zusammenstellzeichnung falls nicht anders vereinbart.**

*Jaws according to assembly drawing if not agreed otherwise.*

**röders  
TEC**



RXP 500 DS / DSC



RXP 501 DS / DSC

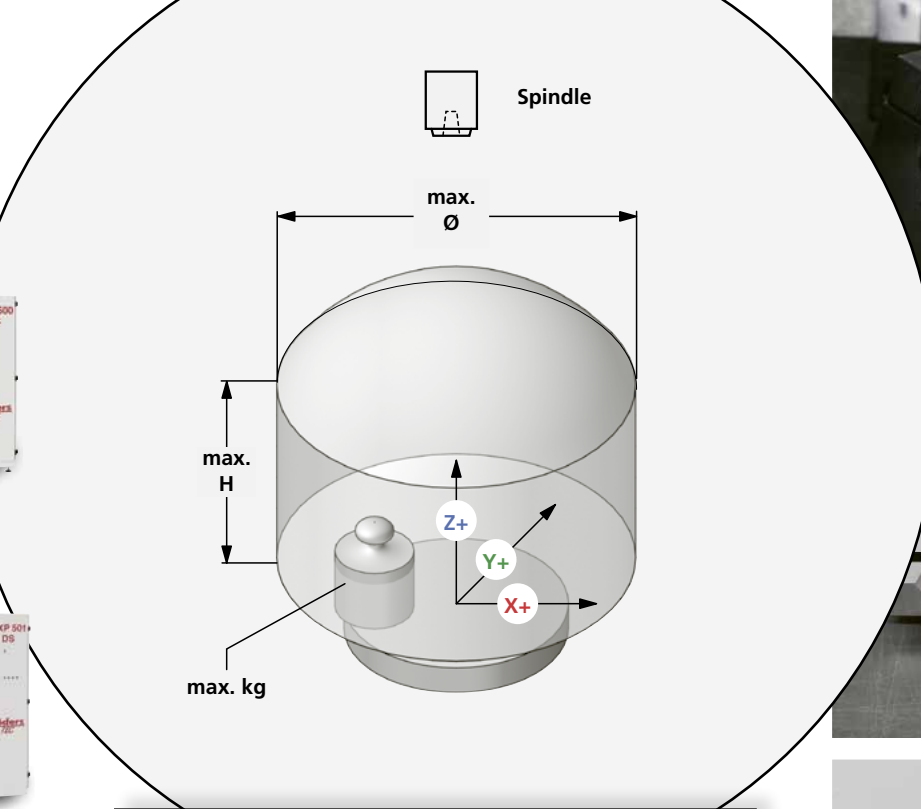

	X	Y	Z	max.		
				Ø	H	kg
RXP500DS	450 (X-316 X+134)	658 (Y-204 Y+454)	240	250	220	60
RXP500DSC	450 (X-316 X+134)	658 (Y-204 Y+454)	240	220	200	30
RXP501DS	500 (X-366 X+134)	700 (Y-230 Y+470)	300	250	200	60
RXP501DSC	500 (X-366 X+134)	700 (Y-230 Y+470)	300	220	200	30

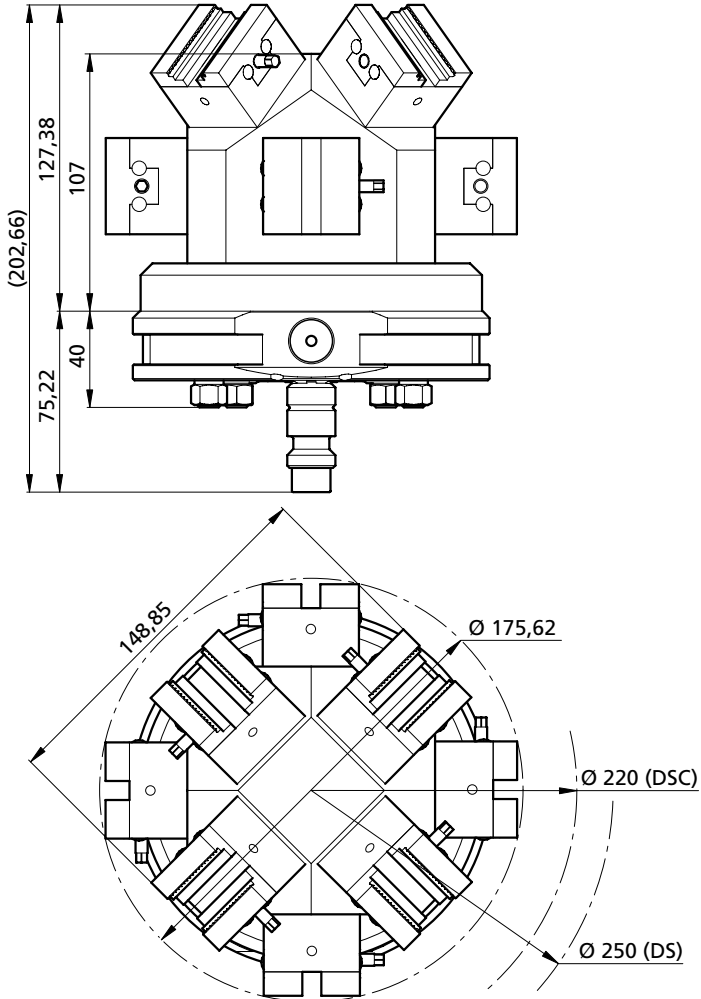
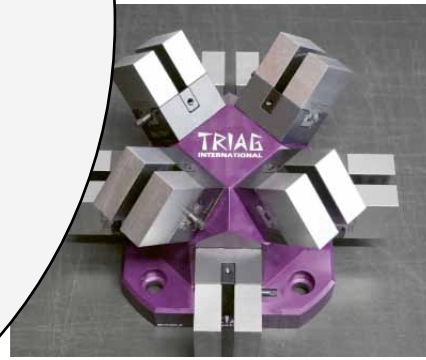

**MICRO**

Backenvarianten  
Jaw variants

Mehr auf Seite 11  
More on page 11

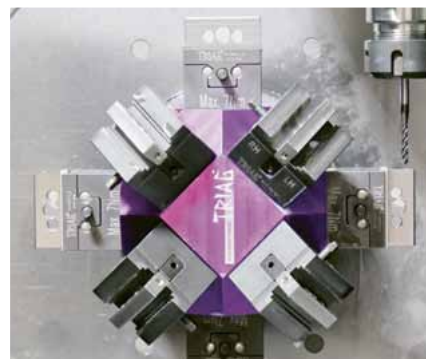
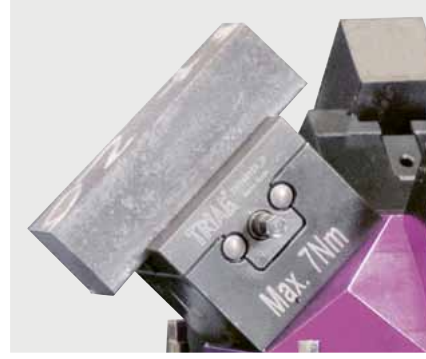



# triCENTRO

Mini-Zentrischspanner inkl. Adapterflansch  
 Mini self centering vises incl. adapter flange

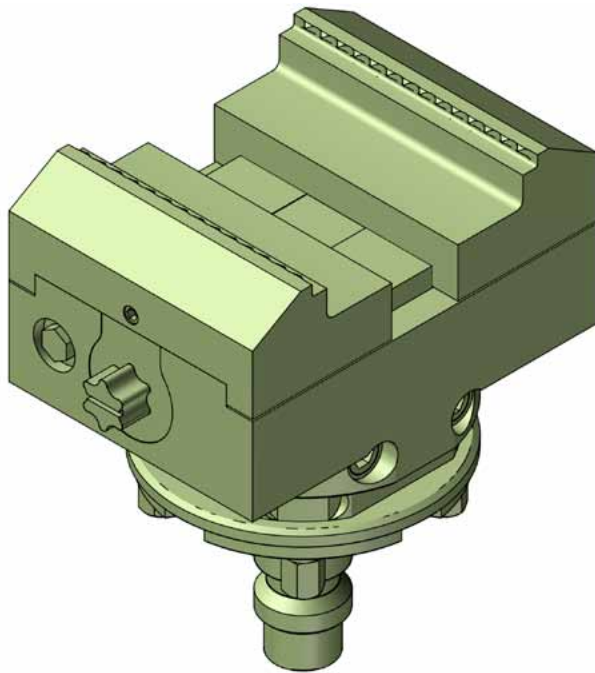

**14**

**Backenvarianten**  
*Jaw variants*

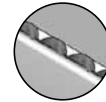

**3mm Direkt-Prägebacken**  
*3mm Direct stamping jaws*

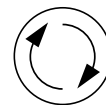

**Backen-Schnellwechselsystem**  
*Quick-change jaw system*



**Beste Zugänglichkeit**  
*Best accessibility*

Bestellschlüssel <i>Order code</i>	Bezeichnung <i>Description</i>	~ Kg	Spannstellen <i>Clamping areas</i>	Spannbereich <i>Clamping area</i>
 <b>RD500-SET4</b>	Röders Set 4	<b>3,02</b>	<b>1</b>	<b>44 - 64</b>



Drehmoment <i>Torque</i>		Spannkraft <i>Workholding force</i>		
Nm	(lb-ft)	~daN	~(lb)	~t
10	7,4	= 200	440	0,2
20	14,8	= 500	1'102	0,5
30	22,2	= 1'000	2'204	1,0
40	29,6	= 1'300	2'866	1,3
50	37,0	= 1'600	3'527	1,6

**Backen gemäss Zusammenstellzeichnung falls nicht anders vereinbart.**

*Jaws according to assembly drawing if not agreed otherwise.*



**röders**  
TEC



RXP 500 DS / DSC



RXP 501 DS / DSC

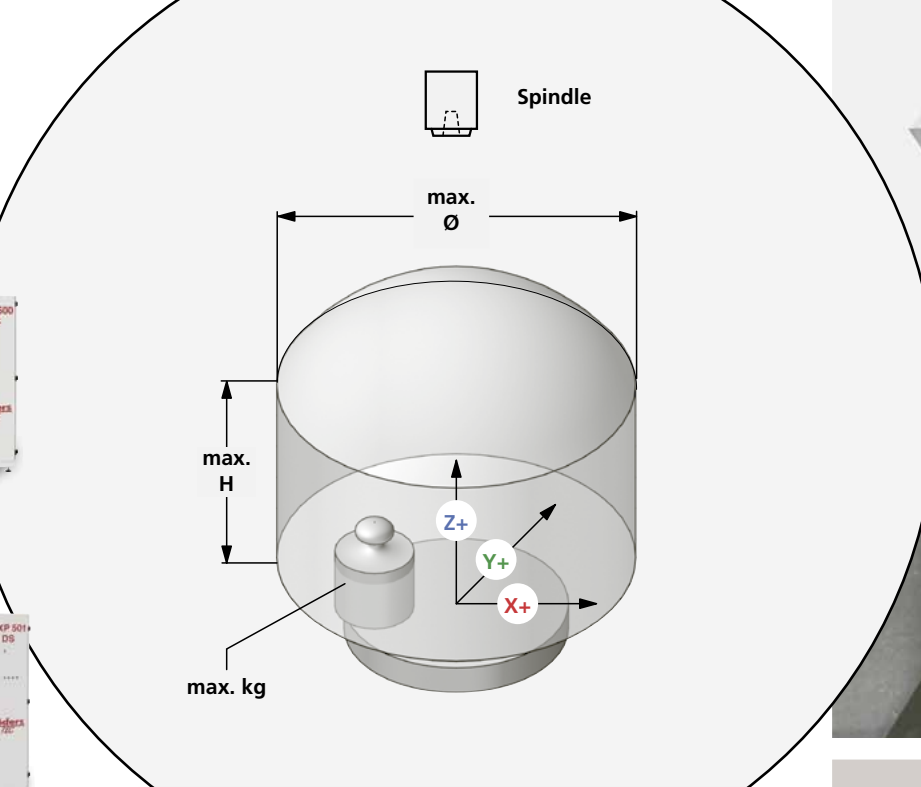

	X	Y	Z	max.		
				Ø	H	kg
RXP500DS	450 (X-316 X+134)	658 (Y-204 Y+454)	240	250	220	60
RXP500DSC	450 (X-316 X+134)	658 (Y-204 Y+454)	240	220	200	30
RXP501DS	500 (X-366 X+134)	700 (Y-230 Y+470)	300	250	200	60
RXP501DSC	500 (X-366 X+134)	700 (Y-230 Y+470)	300	220	200	30

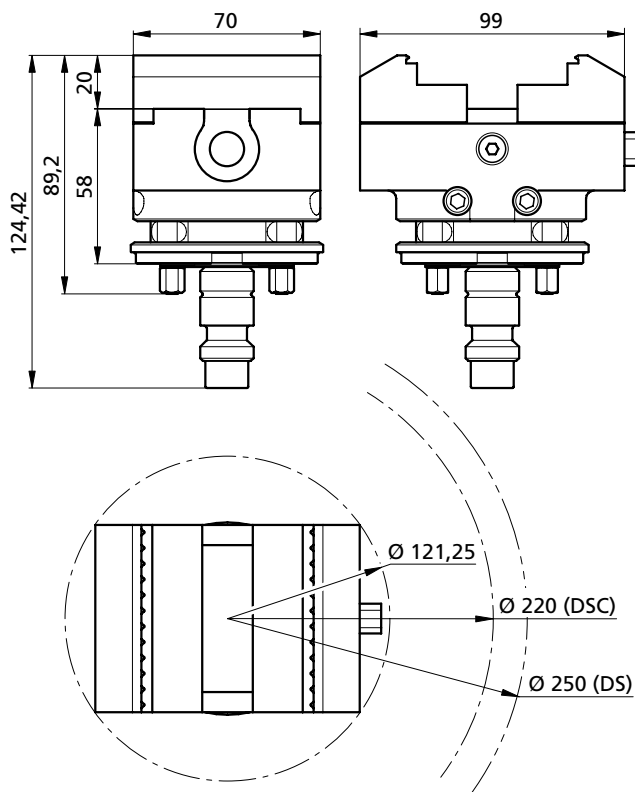
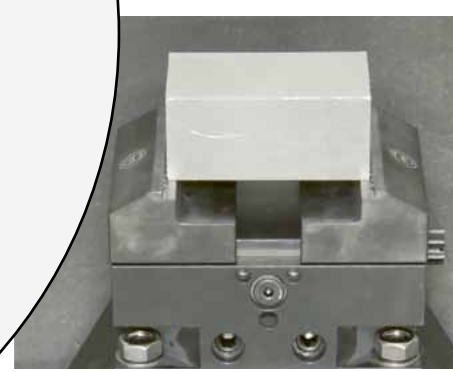
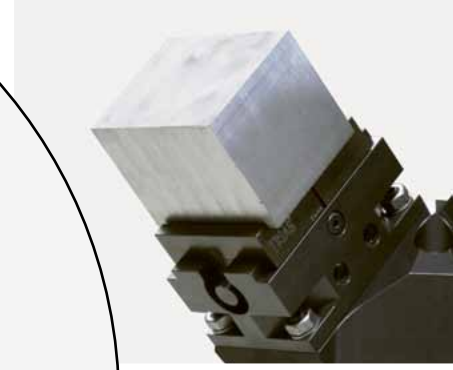

**MINI**

**Backenvarianten**  
Jaw variants

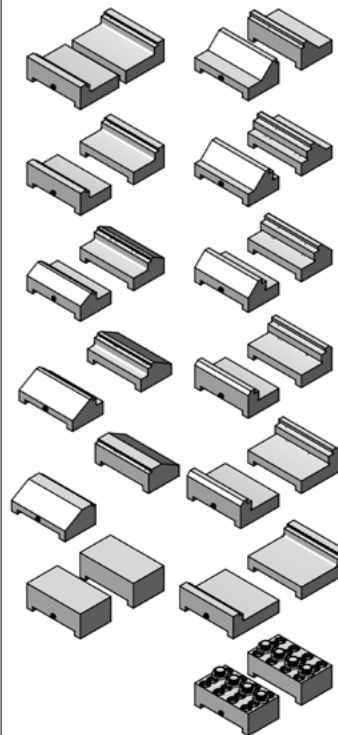

Mehr auf Seite 10  
More on page 10

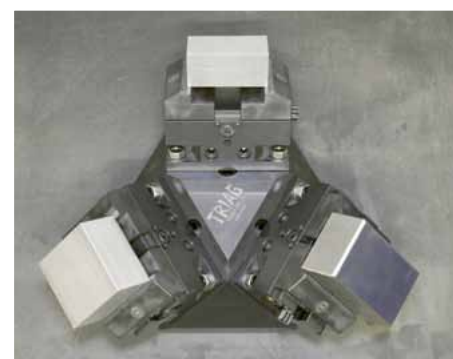

Drehmoment Torque		Spannkraft Workholding force		
Nm	(lb-ft)	~daN	~(lb)	~t
10	7,4	= 200	440	0,2
20	14,8	= 500	1'102	0,5
30	22,2	= 1'000	2'204	1,0
40	29,6	= 1'300	2'866	1,3
50	37,0	= 1'600	3'527	1,6

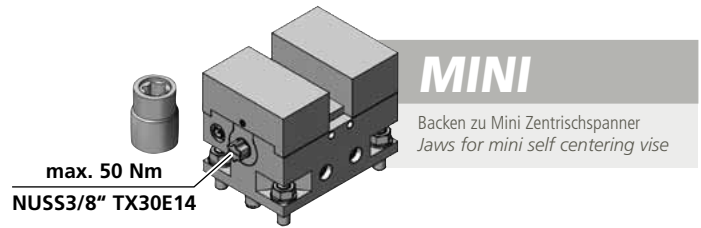

Prägebacken Stamping jaws	<b>B175-26</b> Spannereich / Clamping range <b>6-26 mm</b>  C = 70 H = 20 L = 40 i 57HRC	<b>B175-45</b> Spannereich / Clamping range <b>25-45 mm</b>  C = 70 H = 20 L = 40 i 57HRC	<b>B175-64</b> Spannereich / Clamping range <b>44-64 mm</b>  C = 70 H = 20 L = 40 i 57HRC	
	<b>B175-83</b> Spannereich / Clamping range <b>63-83 mm</b>  C = 70 H = 20 L = 40 i 57HRC	<b>B175-102</b> Spannereich / Clamping range <b>83-102 mm</b>  C = 70 H = 20 L = 50 i 57HRC	<b>B175-121</b> Spannereich / Clamping range <b>101-121 mm</b>  C = 70 H = 20 L = 60 i 57HRC	
	<b>B173-26</b> Spannereich / Clamping range <b>6-26 mm</b>  C = 70 H = 24 L = 40 i HV700 x 0,2 mm	<b>B173-45</b> Spannereich / Clamping range <b>25-45 mm</b>  C = 70 H = 24 L = 40 i HV700 x 0,2 mm	<b>B173-64</b> Spannereich / Clamping range <b>44-64 mm</b>  C = 70 H = 24 L = 40 i HV700 x 0,2 mm	
<b>B173-83</b> Spannereich / Clamping range <b>63-83 mm</b>  C = 70 H = 24 L = 40 i HV700 x 0,2 mm	<b>B173-102</b> Spannereich / Clamping range <b>82-102 mm</b>  C = 70 H = 24 L = 50 i HV700 x 0,2 mm	<b>B170, B172 (weich / soft)</b> Spannereich / Clamping range <b>0-20 mm</b>  C = 70 H = 24 L = 40 i HV700 x 0,2 mm		
<b>B176-80</b> Spannereich / Clamping range <b>8-80 mm</b>  *PRG1003M8 C = 70 H = 24 L = 40 *PRG1003M8 Optional erhältlich / Optional accessory	<b>Zum Erstellen Ihrer individuellen Formbacke:</b> Maximalen Bearbeitungsprofiltiefe <b>If a dedicated jaw is being machined:</b> Max. workpiece machining depth			

Für mehr Informationen, Zubehör oder Backensets > [Gesamtkatalog/triCENTRO](#)  
 For further informations, accessories or jaw sets > [General catalogue/triCENTRO](#)

# MICRO

Backen zu micro Zentrischspanner  
Jaws for mini self centering vise

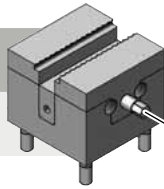

max. 7 Nm  
NUSS1/4" 4,5mm

Drehmoment Torque		Spannkraft Workholding force		
Nm	(lb-ft)	~daN	~(lb)	~t
4	3	= 457	1'007	0,46
5	3,7	= 571	1'259	0,57
6	4,4	= 686	1'512	0,69
7	5,2	= 800	1'764	0,8

	B190-13	B190-22	B190-31
 Prägebacken Stamping jaws	Spannbereich / Clamping range <b>3-13 mm</b>	Spannbereich / Clamping range <b>12-22 mm</b>	Spannbereich / Clamping range <b>21-31 mm</b>
 Formbacke weich Dedicated jaws	Spannbereich / Clamping range <b>0-10 mm</b> <p>                             H1 = 2,2                              H = 6                              i 1.7225                         </p>	Spannbereich / Clamping range <b>0-10 mm</b> <p>                             H1 = 6,2                              H = 10                              i 1.7225                         </p>	Spannbereich / Clamping range <b>0-10 mm</b> <p>                             H1 = 16,2                              H = 20                              i 1.7225                         </p>
 Formbacke weich Dedicated jaws	Spannbereich / Clamping range <b>0-10 mm</b> <p>                             H1 = 26,2                              H = 30                              i 1.7225                         </p>	<p> <b>H1: Zum Erstellen Ihrer individuellen Formbacke:</b>                              Schnittzeichnung zum Ermitteln der max. Bearbeitungsprofiltiefe                         </p> <p> <b>H1: If a dedicated jaw is being machined:</b>                              Sectional drawing to determine the maximum machining depth.                         </p>	

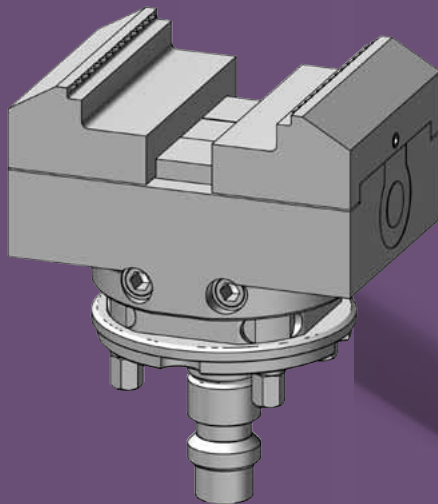
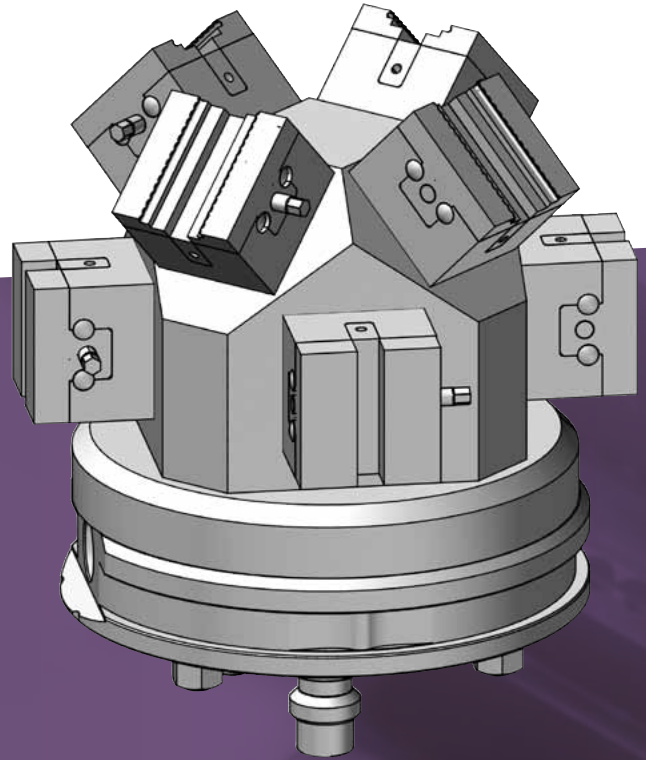
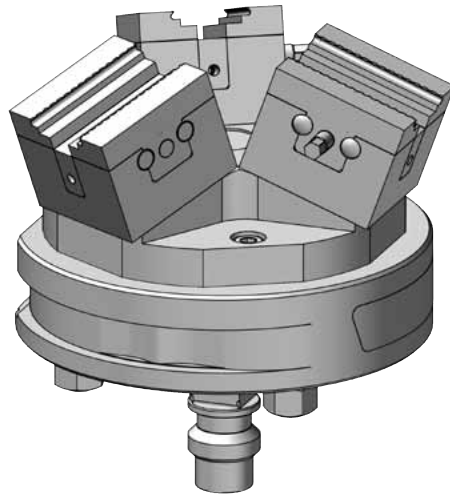

**Triag International AG**

Bösch 84 CH-6331 Hünenberg

☎ +41 41 727 27 77

✉ [spannen@triag-int.ch](mailto:spannen@triag-int.ch)

✉ [clamping@triag-int.ch](mailto:clamping@triag-int.ch)

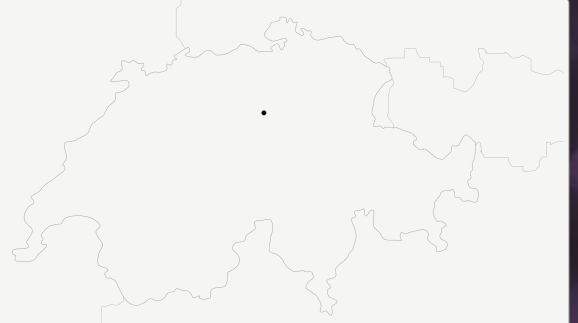

Mass- und Konstruktionsänderungen  
bleiben uns vorbehalten. *We reserve  
the right to modify dimensions and  
structural design.*

**triag-int.ch**

Official Website



**11**  
**21**