

MS1R/F35L14-150

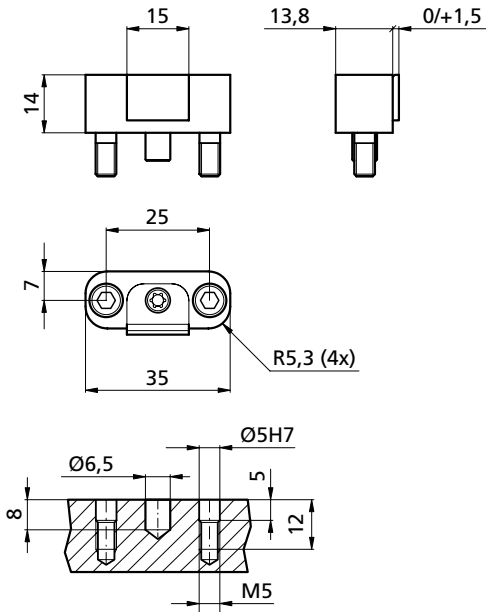

Drehmoment Torque		Spannkraft Workholding force		
Nm	(lb-ft)	~daN	~(lb)	~t
7	5,18	= 390	860	0,39
8	5,92	= 450	990	0,45
9	6,66	= 510	1120	0,51
10	7,4	= 570	1250	0,57

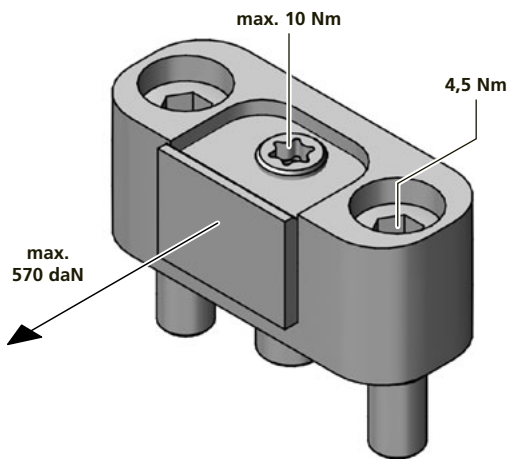

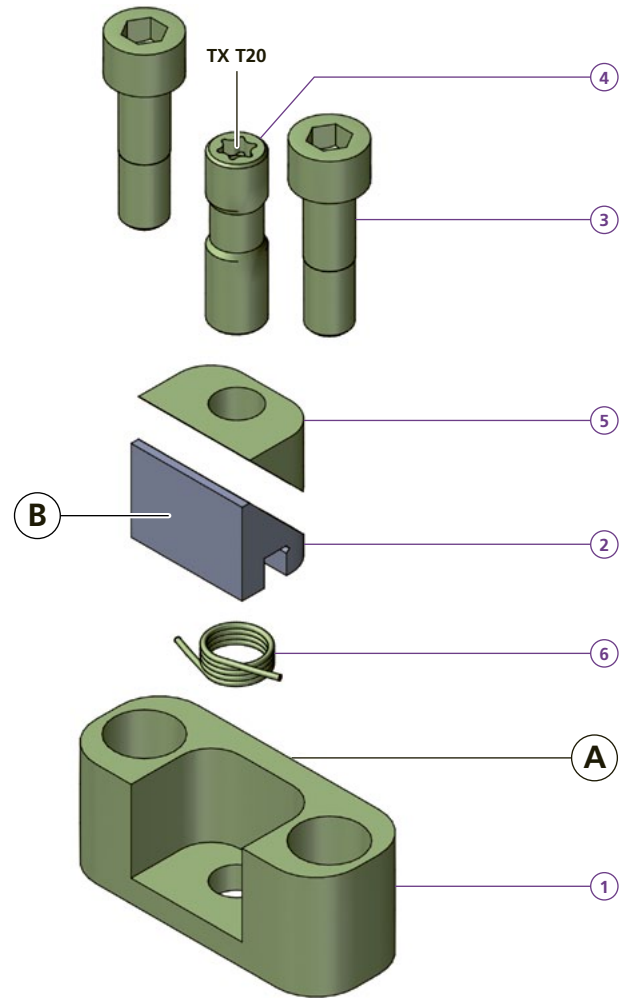

Montageanleitung / Mounting instruction

Positionieren des Gewindestiftes vor Aufsetzen des Spannkeils (B)

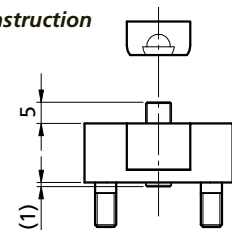
Before mounting the wedge the clamping screw must be positioned (B)

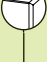

Achtung: Bei Spannkraften über 400 daN (0,4t) sollte das Spannmodul in eine Nut eingelassen werden (Nuttiefe mindestens 1mm)
Remark: Using forces higher than 400 daN, clamps must be mounted into a slot (depth min. 1mm)

MS1F35L14-150	
1x TF140716	
MS1R35L14-150	
1x TF140717	
1x _____	
2x MS50	
1x GEWST6L20	
1x MSK15W45	
1x SFED6W90	
kg ~0,03	

Bestellbeispiel / Ordering example: 1x MS1F35L14-150 & 1x B151	
B	B150 B151
C	15 15
H	11 11
L	40,3 40,3
e	40 40
i	HV700 HV700
	x0,2mm x0,2mm
kg	~0,004 ~0,004

B150, B151

